

**This electronic collection of documents is provided  
for the convenience of the user  
and is Not a Certified Document –**

**The documents contained herein were originally issued  
and sealed by the individuals whose names and license  
numbers appear on each page, on the dates appearing  
with their signature on that page.**

**This file or an individual page  
shall not be considered a certified document.**

VICINITY MAP  
SR 1003 (BUFFALO SHOALS RD)  
CATAWBA COUNTY

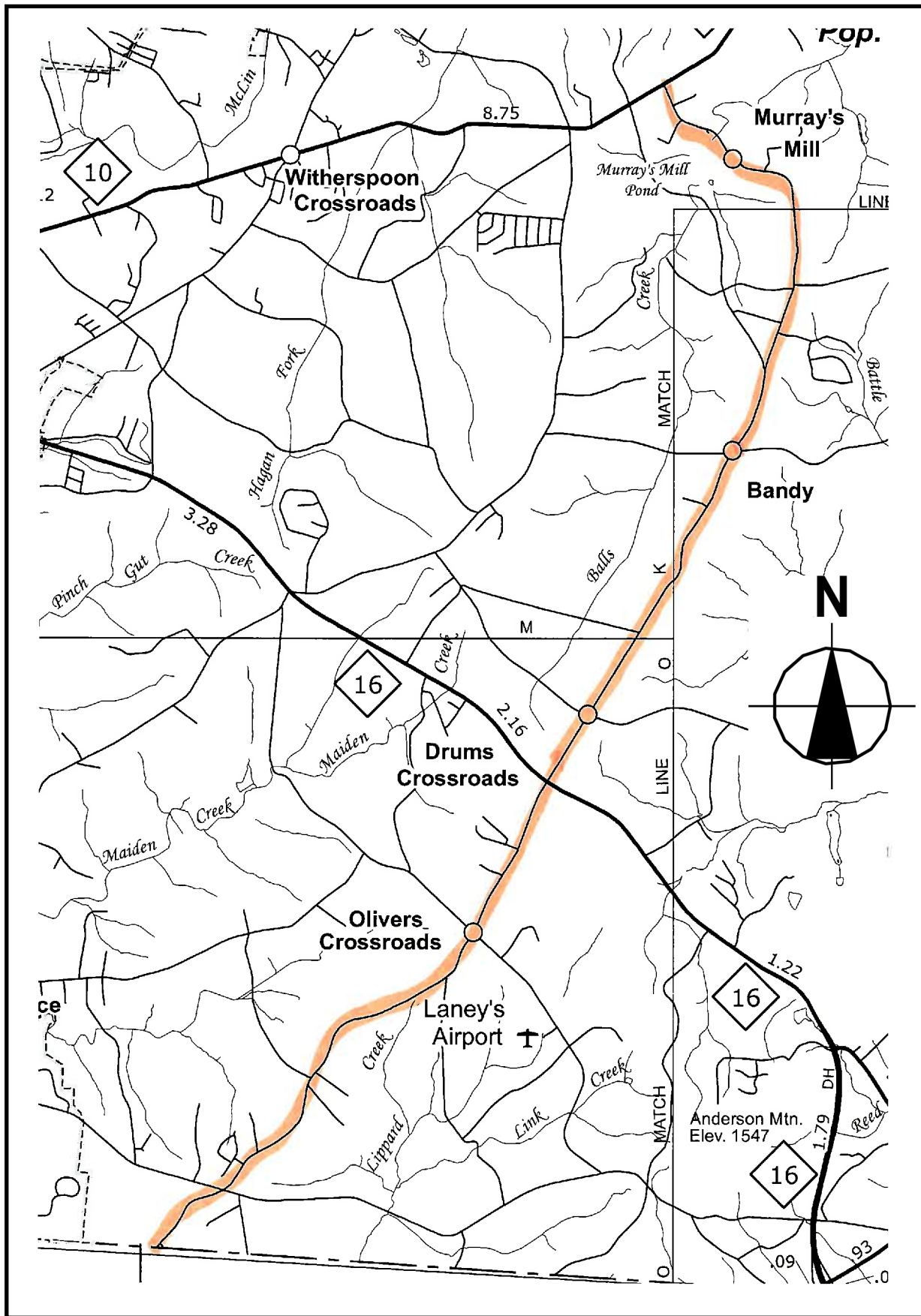

NO SCALE

VICINITY MAP  
SR1855 (E. MAIDEN RD)  
CATAWBA COUNTY

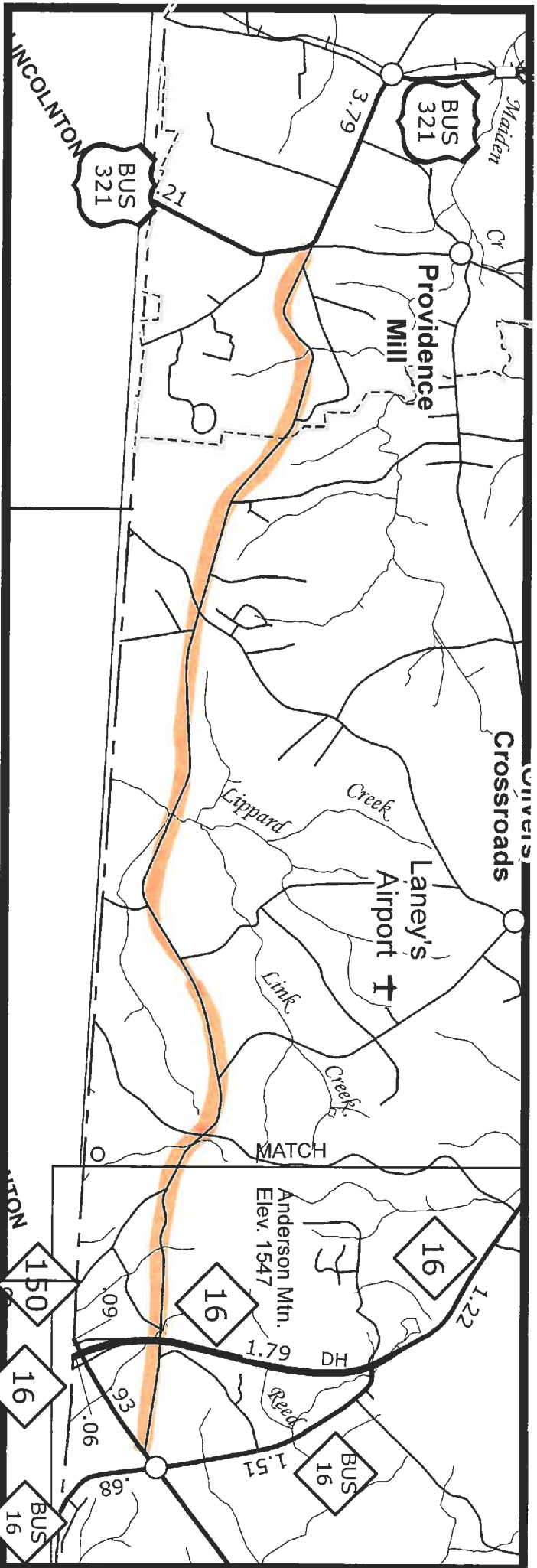
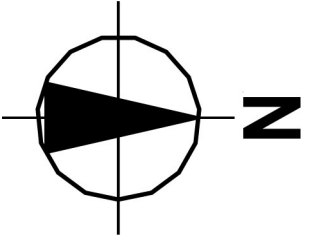

NO SCALE

VICINITY MAP  
SR 1511 (OLD PLANK RD)  
LINCOLN COUNTY

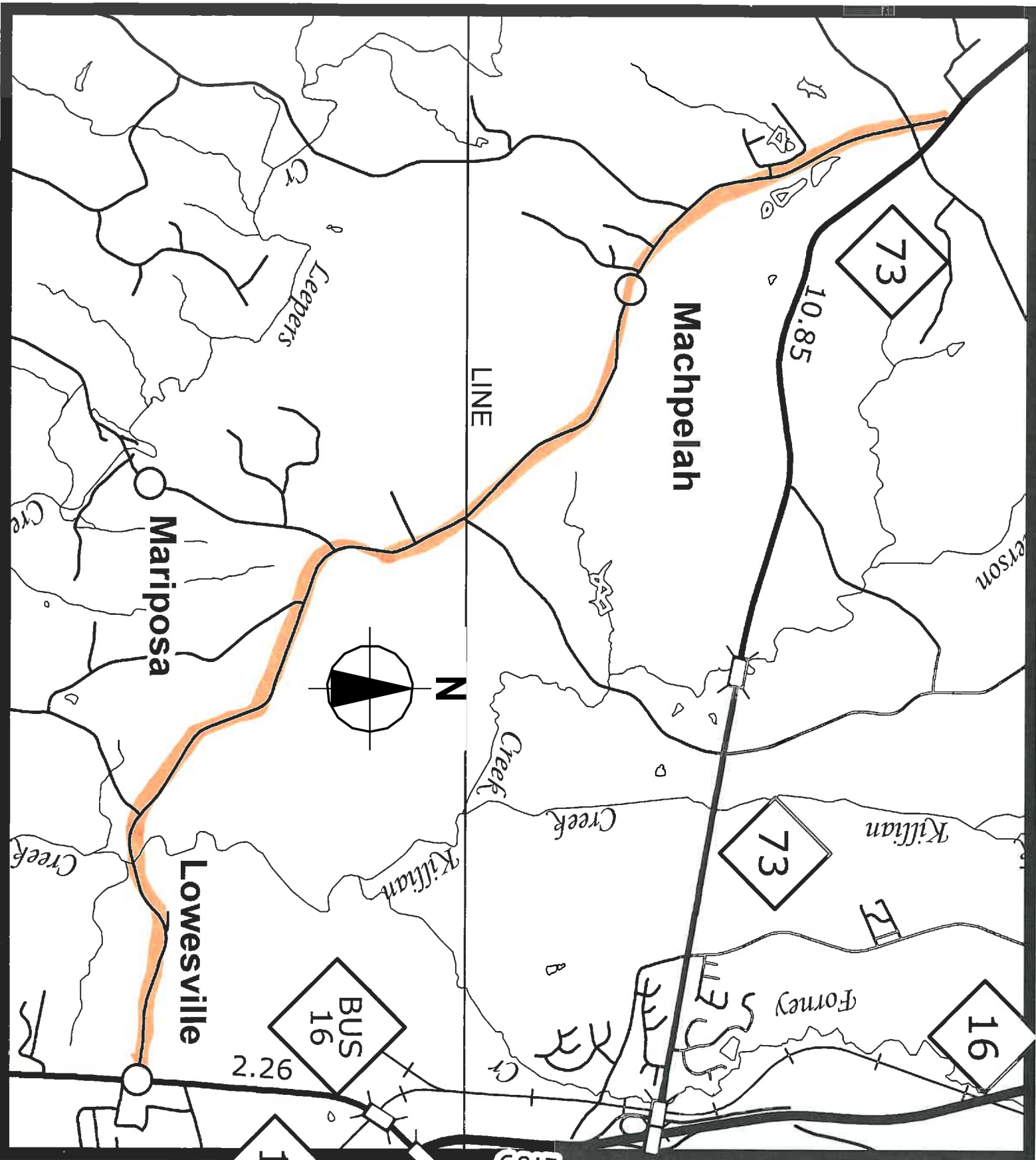

NO SCALE

VICINITY MAP  
SR 1113 (REEPSVILLE RD)  
LINCOLN COUNTY

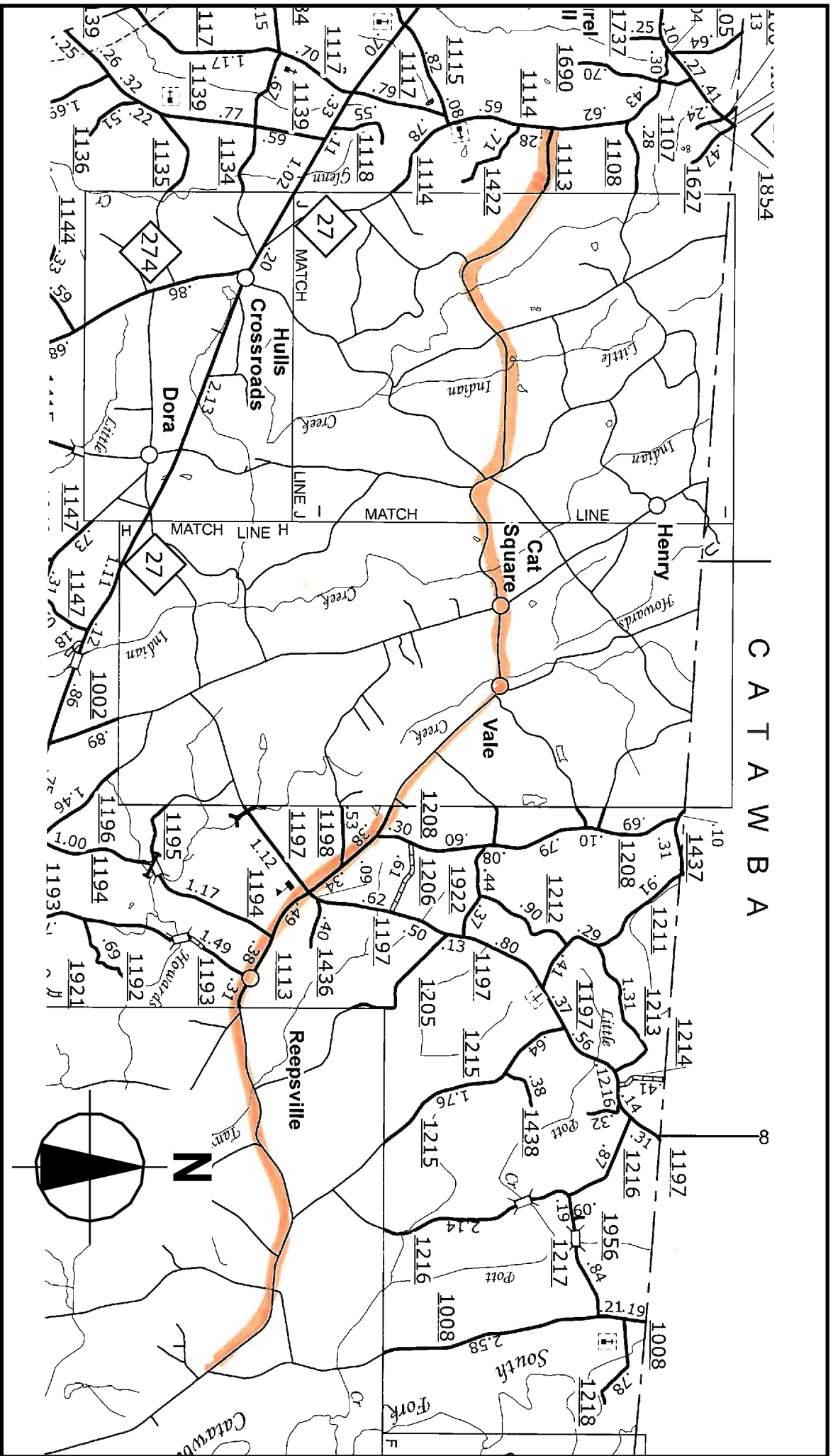

NO SCALE

VICINITY MAP  
SR 1373 (CAMPGROUND RD)  
LINCOLN COUNTY

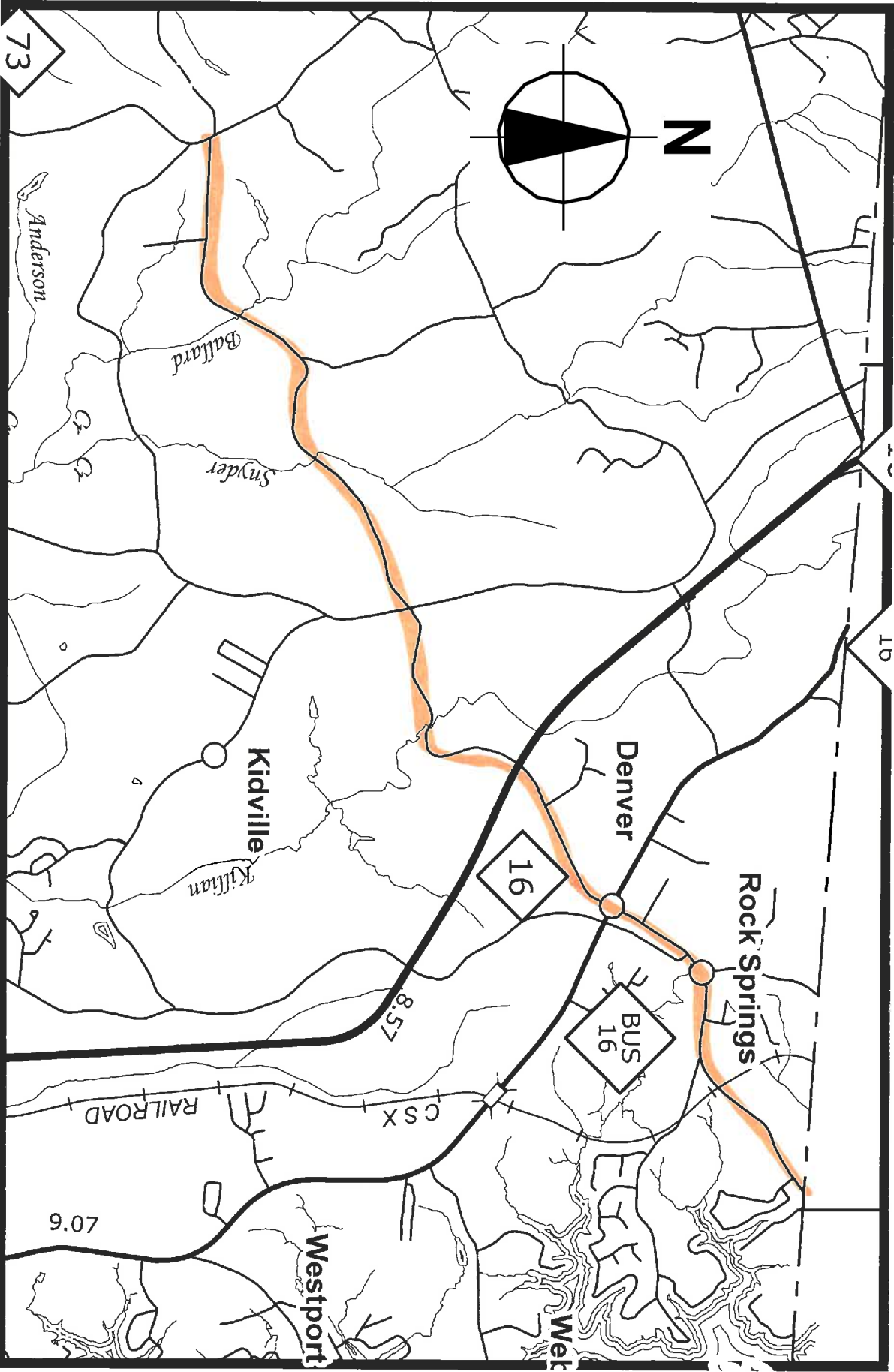

NO SCALE



SUMMARY OF POLYUREA QUANTITIES							
WBS No.	COUNTY	SECONDARY ROAD No.	DESCRIPTION	MILES	4", 30 mil WHITE POLYUREA (HIGHLY REFLECTIVE ELEMENTS) (LF)	4", 30 mil YELLOW POLYUREA (HIGHLY REFLECTIVE ELEMENTS) (LF)	4" EXISTING LINE REMOVAL (LF)
44858.3.15	CATAWBA	1003 (Buffalo Shoals Rd)	FROM LINCOLN CO. TO NC 10	11.092	117,130	117,130	234,260
44858.3.15	CATAWBA	1855 (E. Maiden Rd)	FROM US 321 BUS. TO NC 150	7.963	84,088	84,088	168,176
44858.3.14	LINCOLN	1113 (Reepsville Rd)	FROM SR 1114 (N. BROOK III SCH. RD) TO SR 1008 (KILLIAN RD)	12.023	126,962	126,962	253,924
44858.3.14	LINCOLN	1373 (Christopher Rd, Forney Hill Rd, Wingate Hill Rd, Campground Rd)	FROM SR 1362 (AMITY CH RD) TO CATAWBA CO.	7.612	80,382	80,382	160,764
44858.3.14	LINCOLN	1511 (Old Plank Rd)	FROM NC 73 TO NC 16 BUS.	6.494	68,576	68,576	137,152
<b>PROJECT TOTAL</b>				<b>45.184</b>	<b>477,138</b>	<b>477,138</b>	<b>954,276</b>
					<b>954,276</b>		